



FOR K-12

Expand Your Math Experience

Pair Imagine IM core and the adaptive practice companion to provide even more students equitable access to grade-level math

The image illustrates the integration of Imagine IM core and adaptive practice. The laptop displays an instructional video interface for a 3.2 Unit Launch, featuring a grid diagram with dimensions and a sidebar for annotations. The tablet displays an adaptive practice interface for finding the area of a rug, showing a grid and several mathematical expressions for selection. The interface includes a progress bar, a 'Welcome, Kelly' message, and a sidebar with 'MATH HELP', 'TOOLS', and 'Language' options.

Nurture Active Math Learners

Inviting lesson designs combine with deep personalization to engage all students

Imagine Learning helps students from kindergarten through high school hone critical math skills and habits of mind. Our **Imagine IM**® core and **adaptive practice companion** supplemental solutions feature inclusive instructional routines, immersive activities, real-world connections, and digital tools that promote thinking and reasoning. Plus, actionable data empowers teachers to inform instruction and improve math outcomes for every student.



Rigorous, technology-enhanced core math instruction

An immersive learning experience with features that present math in contexts beyond the classroom. Tools, such as virtual manipulatives, digital applets, and annotation, foster interaction and engagement.

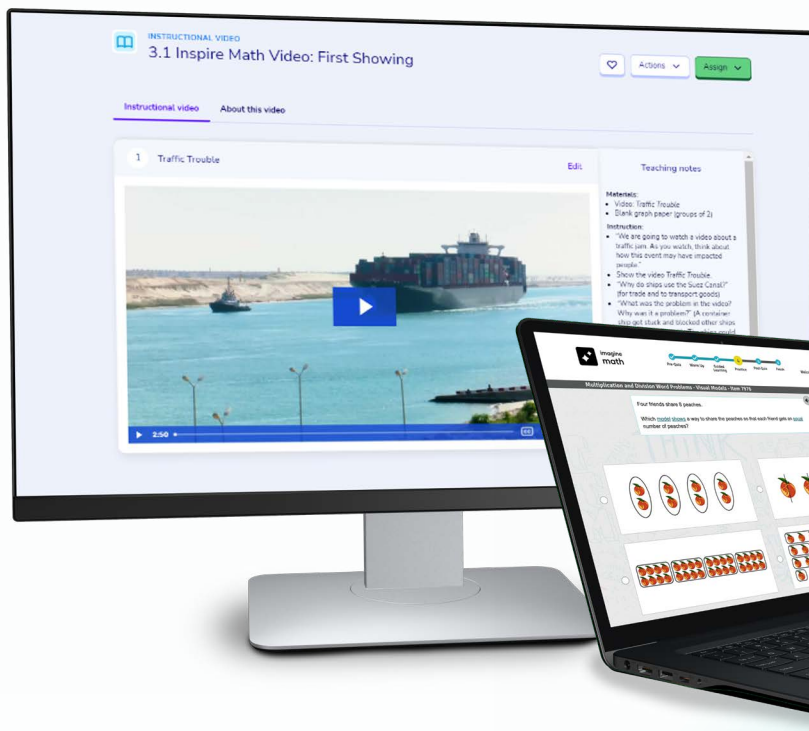

● Imagine IM Grade 3, Unit 1: Introducing Multiplication

● Imagine Math Grade 3: Multiplication and Division Word Problems - Visual Models

Adaptive Practice Companion



Dynamic supplemental math practice and enrichment

Scaffolded Imagine Math “Help” options, embedded digital math tools, and a focus on academic discourse promote critical thinking for grade-level success.

Give students a head start on college and career readiness by fostering the 4Cs of STEM

Together, **Imagine IM core** and the **adaptive practice companion** strengthen:

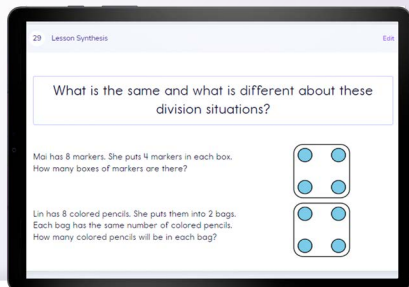

The adaptive practice companion Grade 3:
Area of Rectangles and Live Teacher access

Imagine IM Grade 3, Unit 4, Lesson 3:
Division Situation Drawings

Adaptive Practice Companion

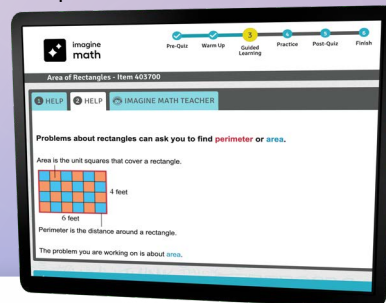

CRITICAL THINKING

Students develop critical thinking skills as they grapple with rigorous problems in **Imagine IM** and apply their conceptual understanding to word problems in the adaptive practice companion.

CREATIVITY

Imagine IM's open-ended instructional routines encourage students to think creatively. The adaptive practice companion complements the core instruction using multiple representations to present mathematical concepts.



COMMUNICATION

Students work on communication in **Imagine IM's** discourse-focused synthesis activities and as they apply vocabulary and reasoning skills to the adaptive practice companion's journaling printables.

COLLABORATION

Students collaborate with peers to work toward a shared understanding in Partners/Small Group Activities in **Imagine IM** and comprehensive STEM-focused Application Tasks in the adaptive practice companion.

Help All K–2 Learners Thrive in Your Math Classroom

Use Imagine IM for your core daily instruction, differentiate and enhance with the adaptive practice companion

In *Imagine IM*, students learn how to be a valuable member of the mathematical community in their classroom as they engage with digital, print, and interactive resources, including virtual manipulatives and digital centers.

To enhance core daily math lessons, the adaptive practice companion offers learning activities, songs, games, and more for whole-class or small-group instruction. Reach your primary learners with a variety of instructional content designed to activate all learning styles or for differentiation to support core concepts.



● Pictured: *Imagine IM* Digital Centers



Use the Imagine IM crosswalk in the adaptive practice companion

Access the **Imagine IM** crosswalk in **Imagine Math** Teacher Resources.

- Pictured: **Imagine IM Grades PreK–2 Pathways crosswalk document**



Imagine Learning Illustrative Math Pathways Grades PreK–2

1

Imagine Learning Illustrative Math Grade 1

Unit #	Unit Name	Description	Section	Section Goal	Imagine Math Associated Content (Lessons, songs, games, and instructions to navigate to content in the product)
1	Adding, Subtracting, and Working with Data	Students add and subtract within 10, and represent and interpret categorical data.	A: Add and Subtract Within 10	Build toward fluency by adding and subtracting within 10 in a way that makes sense to them.	<ul style="list-style-type: none"> • (Math Game) On the Fly • (Math Game) Tiger Claw • (Math Game) Lion Leap • (Math Game) Sneaky Snake • (Math Game) Ra Ra Raccoons [Lessons] G1: <ul style="list-style-type: none"> • Comparing, ordering, and number composition within 5 • 2D shapes, counting, and number composition within 5 • Adding and subtracting 1 within 10 • Adding and subtracting 2 within 10 • Adding and subtracting 3 within 10 • Adding and subtracting 4 within 10 • Adding 5, 6, 7, and 8 within 10, commutative property of addition • Subtracting 5, 6, 7, and 8 with the difference within 5
1			B: Show Us Your Data	Organize and represent data.	Filter G1 lessons by topic "Data" in the Lesson Explorer. Select activities on topic "Data" within filtered lessons.
1			C: What Does the Data Tell Us?	Interpret data representations to ask and answer questions.	See Section 1.B

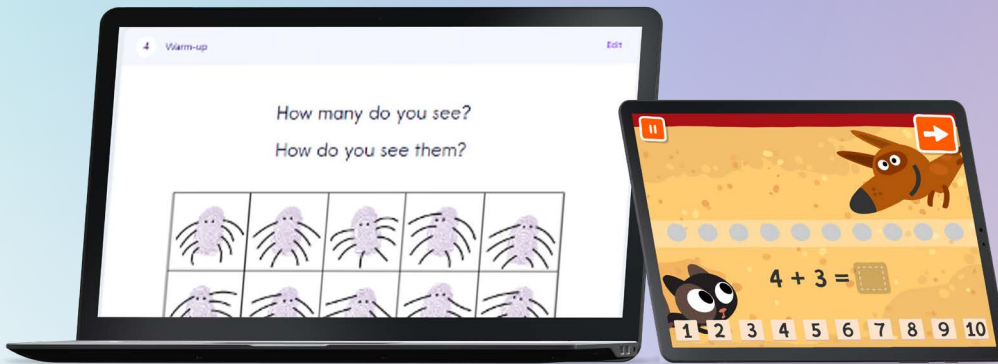

- Example of correlated instructional content: **“Fingerprint Animals (Adding within 10)”** in Illustrative Mathematics kindergarten lesson aligns to **“Working with numbers within 10”** kindergarten activity in Imagine Math.



Plus, with the adaptive practice companion’s three annual benchmark tests powered by the Quantile® Framework for Mathematics, you can easily identify at-risk students and monitor everyone’s progress.

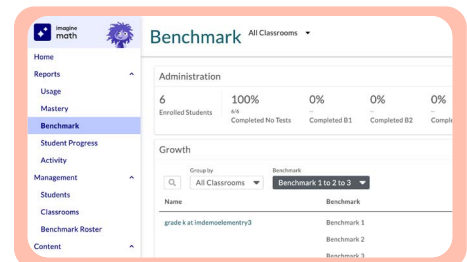

METAMETRICS®, the METAMETRICS® logo and tagline, QUANTILE®, QUANTILE® FRAMEWORK, and the QUANTILE® logo are trademarks of MetaMetrics, Inc., and are registered in the United States and abroad. Copyright © MetaMetrics, Inc. All rights reserved.]

Empower grade 3+ students to own their math learning

Focus on iterative problem solving with Imagine IM core solution, personalize practice and enrichment with the adaptive practice companion

The **Imagine IM** classroom expects and values visible thinking, as students practice taking risks, disagreeing respectfully, and honoring group work time. Adding on the **adaptive practice companion's** custom learning pathways, aligned with **Imagine IM's** scope and sequence, helps reinforce essential math ideas and ensure that all students work toward success with grade level standards. Support your **Imagine IM** learners with personalized, adaptive homework or extended practice printable worksheets from the **adaptive practice companion**, or assign a classwork grade based on feedback from the comprehensive Student Progress Report.

Teachers can use the **adaptive practice companion** for independent practice via center or station work to free themselves up for facilitating small group **Imagine IM** instruction — or assign as homework to save class time for discussing key concepts.



Bridge student support from school to home and everywhere in between with access to certified Live Teachers

Students have on-demand access to rigorous, **bilingual (English/Spanish)** math instruction at their point of need before, during, and after school — even during weekends and school vacations.



Reach out for support from a Live Teacher if needed

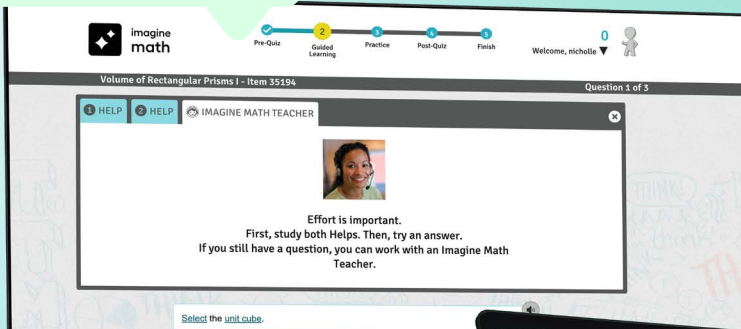

Rigorous grade-level content instruction with Imagine IM

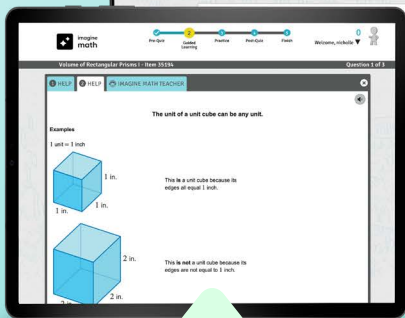

Reinforce concepts with complementary practice



PROFESSIONAL LEARNING

For districts implementing **Imagine IM** with the **adaptive practice companion** supplemental support, you can schedule professional learning to learn how to use them collaboratively — available in person or virtually



Combine an inviting lesson design with deep personalization so all students are engaged, active math learners.

Support the 4Cs of STEM with Imagine Learning's comprehensive math solutions:

	Imagine IM	Adaptive Practice Companion
Critical Thinking	✓	✓
Creativity	✓	✓
Communication	✓	✓
Collaboration	✓	✓



[imaginelearning.com/math](https://www.imaginelearning.com/math)

877-725-4257 • solutions@imaginelearning.com